

## HEX NIPPLES — PIPE THREAD (NPT)

- Stainless steel

PART NO.	CONNECTION TYPES		MAXIMUM OPERATING PRESSURE	
	Connection 1	Connection 2	psi	bar
GP 055-P1P1	1/16 NPT Male	1/16 NPT Male	15k	1000
GP 055-P1P2	1/8 NPT Male	1/16 NPT Male	15k	1000
GP 055-P1P4	1/4 NPT Male	1/16 NPT Male	15k	1000
GP 055-P2P2	1/8 NPT Male	1/8 NPT Male	15k	1000
GP 055-P2P4	1/4 NPT Male	1/8 NPT Male	15k	1000
GP 055-P2P6	3/8 NPT Male	1/8 NPT Male	15k	1000
GP 055-P2P8	1/2 NPT Male	1/8 NPT Male	15k	1000
GP 055-P4P4	1/4 NPT Male	1/4 NPT Male	15k	1000
GP 055-P4P6	3/8 NPT Male	1/4 NPT Male	15k	1000
GP 055-P4P8	1/2 NPT Male	1/4 NPT Male	15k	1000
GP 055-P4P12	3/4 NPT Male	1/4 NPT Male	15k	1000
GP 055-P6P6	3/8 NPT Male	3/8 NPT Male	12k	830
GP 055-P6P8	1/2 NPT Male	3/8 NPT Male	15k	1000
GP 055-P6P12	3/4 NPT Male	3/8 NPT Male	15k	1000
GP 055-P8P8	1/2 NPT Male	1/2 NPT Male	12k	830
GP 055-P8P12	3/4 NPT Male	1/2 NPT Male	15k	1000
GP 055-P8P16	1" NPT Male	1/2 NPT Male	12k	830
GP 055-P12P12	3/4 NPT Male	3/4 NPT Male	12k	830
GP 055-P12P16	1" NPT Male	3/4 NPT Male	10k	700
GP 055-P16P16	1" NPT Male	1" NPT Male	10k	700

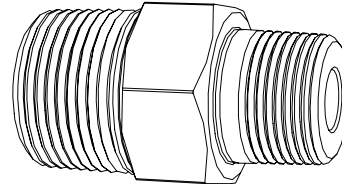

## PIPE THREAD MALE (NPT MALE) TO TYPE M MALE ADAPTERS

- Stainless steel

PART NO.	CONNECTION TYPES		MAXIMUM OPERATING PRESSURE	
	Connection 1	Connection 2	psi	bar
AF 060-P4	9/16 Type M Male	1/4 NPT Male	15k	1000
AF 060-P6	9/16 Type M Male	3/8 NPT Male	15k	1000
AF 060-P8	9/16 Type M Male	1/2 NPT Male	15k	1000
AF 060-P12	9/16 Type M Male	3/4 NPT Male	15k	1000
AF 061-P4	3/4 Type M Male	1/4 NPT Male	15k	1000
AF 061-P8	3/4 Type M Male	1/2 NPT Male	15k	1000
AF 061-P12	3/4 Type M Male	3/4 NPT Male	15k	1000
AF 063-P8	1" Type M Male	1/2 NPT Male	15k	1000
AF 063-P12	1" Type M Male	3/4 NPT Male	15k	1000
AF 063-P16	1" Type M Male	1" NPT Male	12k	830
AF 064-P12	1-5/16 Type M Male	3/4 NPT Male	15k	1000
AF 064-P16	1-5/16 Type M Male	1" NPT Male	12k	830

